

SC2K

CABLE CARRIERS MEDIUM SERIES

Inner Height (A) 35mm	Code	Radius	(A)mm	(B)mm	(C)mm	(D)mm	Weight Kg/Mt
<ul style="list-style-type: none"> • One side is fixed, other (radius) side is openable • Should be used in supporting trays • Suitable for long distances • Both sides have openable covers (caps) 	SC2K 100 R_01	100-150-200	35	100	50	120	1.987gr

Maximum working speed :6M/S

Radius MUST be given in your orders.Example:

SC2K 100 R100

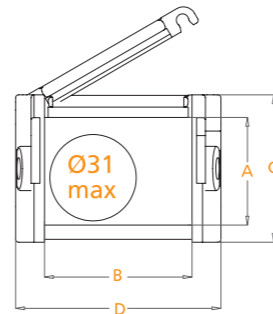

R mm	H mm	X mm	M mm	Y mm
100	56	250	181	426
150	56	350	228	562
200	56	450	288	712

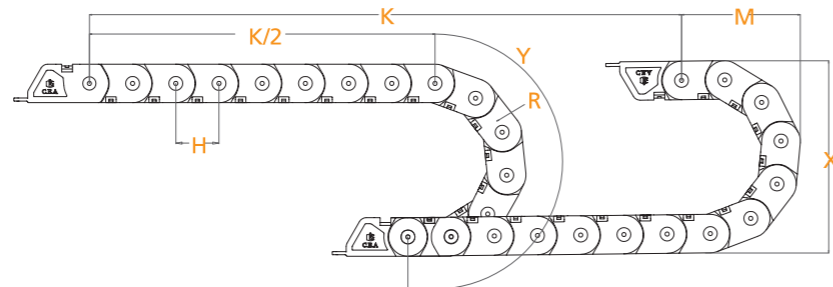

L: Total length to be used

K: Movement distance

Y: Radius

$$L: \frac{K}{2} + Y$$

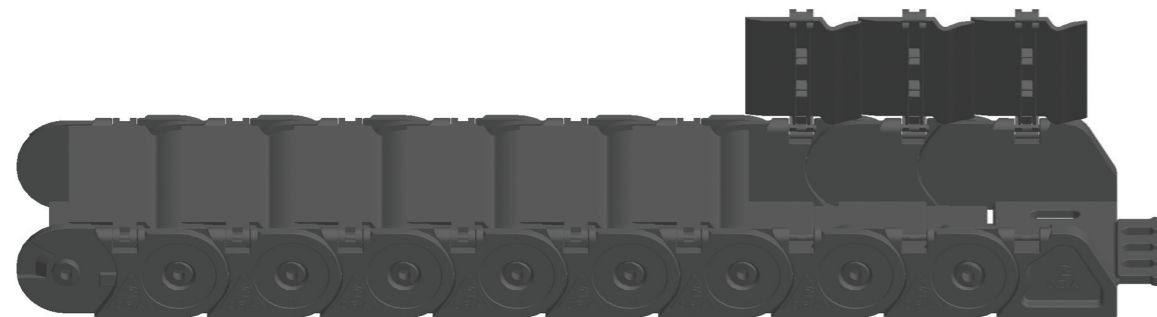

IMPORTANT POINTS

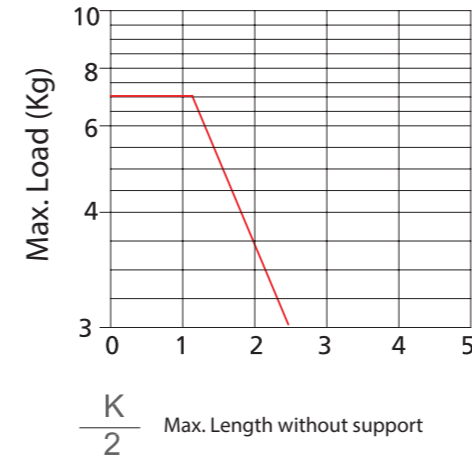

Self-supporting Capacity Diagram

Self-supporting capacity of the cable carrier according to weight of the cables and hoses

$$\frac{K}{2}$$

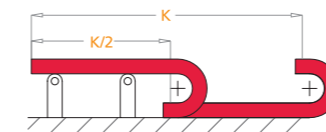

How to use support rollers:

- Support rollers should be used after 3 meters
- Make sure that the cap (cover) is fixed properly
- Use an appropriate hand tool (screw driver) to open the cap
- Be careful not to damage the fixing nail of the cap (cover).

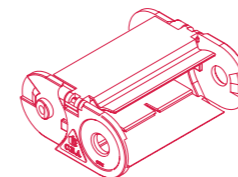
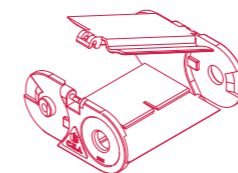

How to choose end bracket

End bracket

End brackets are the parts to be used to fix the cable carrier to the machine or equipment

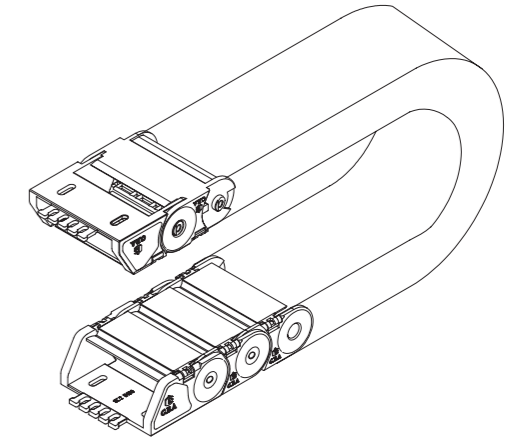

Should be attached to the both ends of the cable carrier.

CABLE CARRIER CODE	END BRACKET CODE	A	B
SC2K 100 R_01	SC2 B100	70	120

