

SC1.1

CABLE CARRIERS MEDIUM SERIES

Inner Height (A) 32mm	Code	Radius	(A)mm	(B)mm	(C)mm	(D)mm	Weight Kg/Mt
<ul style="list-style-type: none"> • One side is fixed, other (radius) side is openable • Should be used in supporting trays • Suitable for long distances • No complete cover (on both sides) • Suitable to use vertical separators 	SC1.1 022 R_01	50-100-150-200	32	22	41	36	0.600gr
	SC1.1 040 R_01	50-100-150-200	32	40	41	56	0.750gr
	SC1.1 060 R_01	50-100-150-200	32	60	41	76	0.820gr
	SC1.1 080 R_01	50-100-150-200	32	80	41	96	0.880gr

Maximum working speed :7M/S

Radius MUST be given in your orders. Example:

SC1.1 060 R100

$$L: \frac{K}{2} + Y$$

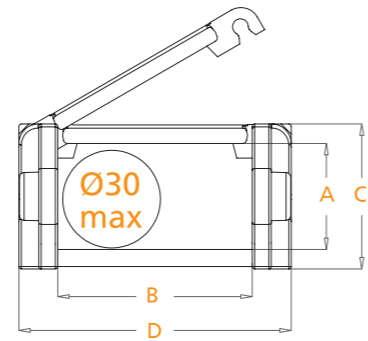

R mm	H mm	X mm	M mm	Y mm
50	50	141	70	257
100	50	241	120	414
150	50	341	170	571
200	50	441	220	728

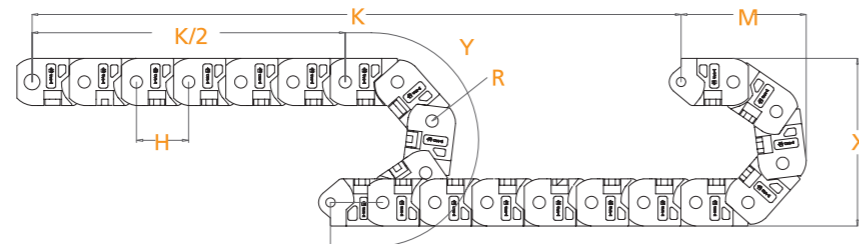

L: Total length to be used

K: Movement distance

Y: Radius

$$L: \frac{K}{2} + Y$$

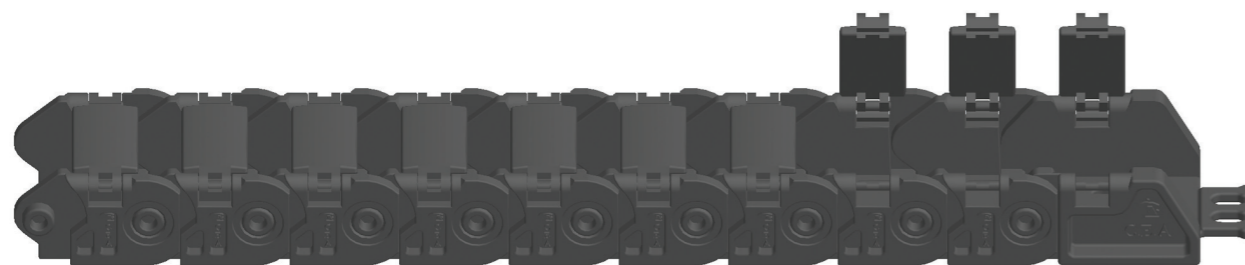

IMPORTANT POINTS

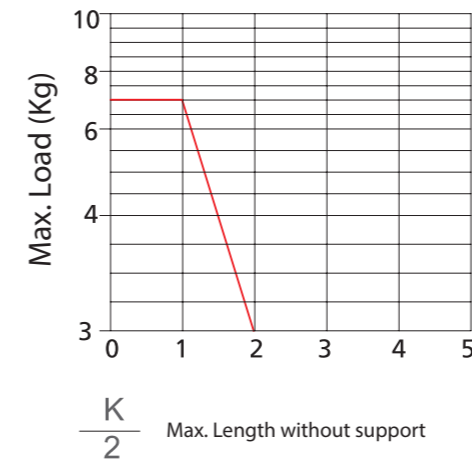

Self-supporting Capacity Diagram

Self-supporting capacity of the cable carrier according to weight of the cables and hoses $\frac{K}{2}$

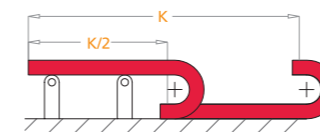

How to use support rollers:

- Support rollers should be used after 2,5 meters
- Make sure that the cap (cover) is fixed properly
- Use an appropriate hand tool (screw driver) to open the cap
- Be careful not to damage the fixing nail of the cap (cover)

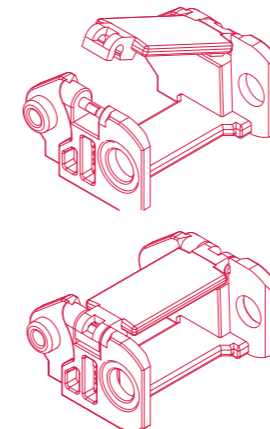

How to choose end bracket

End bracket

End brackets are the parts to be used to fix the cable carrier to the machine or equipment .

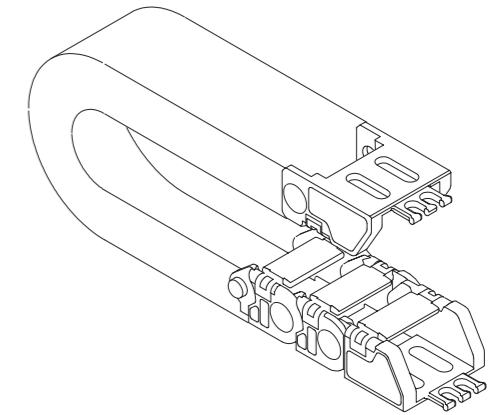

Should be attached to the both ends of the cable carrier

CABLE CARRIER CODE	END BRACKET CODE	A	B
SC1.1 022 R_01	SC1.1 B022	10	36
SC1.1 040 R_01	SC1.1 B040	20	56
SC1.1 060 R_01	SC1.1 B060	40	76
SC1.1 080 R_01	SC1.1 B080	60	96

