

# SA2

## CABLE CARRIERS LIGHT SERIES

Inner Height (A) 12mm	Code	Radius	(A)mm	(B)mm	(C)mm	(D)mm	Weight Kg/Mt
<ul style="list-style-type: none"> <li>No cover (cap) on top and bottom sides</li> <li>Should be used in supporting trays</li> <li>Suitable for short movement lengths</li> </ul>	SA2 012 R_01	18-25-35-48	12	12	15	18	0.168gr

Maximum working speed :5M/S

Radius MUST be given in your orders.Example:

SA2 012 R18

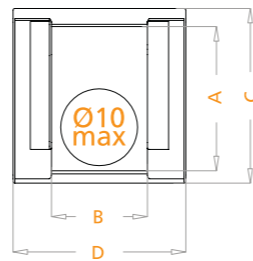

R mm	H mm	X mm	M mm	Y mm
18	17	52	43	91
25	17	66	50	113
35	17	86	60	144
48	17	112	73	185

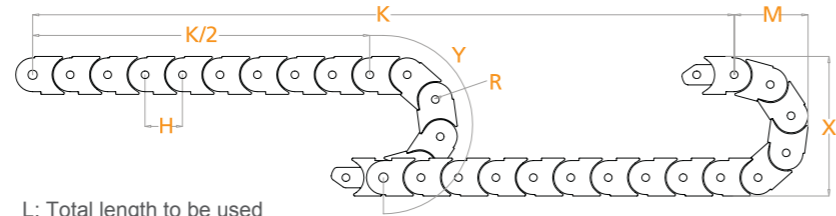

L: Total length to be used  
K: Movement distance  
Y: Radius

$$L: \frac{K}{2} + Y$$



### IMPORTANT POINTS

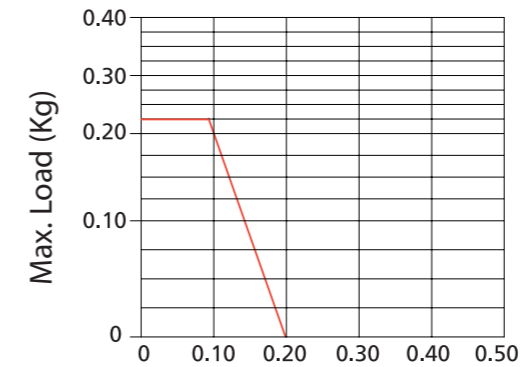

#### Self-supporting Capacity Diagram

Self-supporting capacity of the cable carrier according to weight of the cables and hoses

$$\frac{K}{2}$$

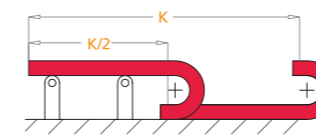

How to use support rollers:  
• Support rollers should be used after 0.5 meter  
• End brackets are metal

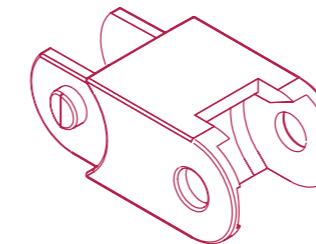

### How to choose end bracket

#### End bracket

End brackets are the parts to be used to fix the cable carrier to the machine or equipment

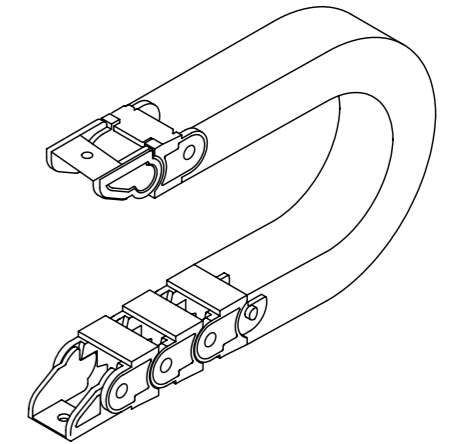

Should be attached to the both ends of the cable carrier

CABLE CARRIER CODE	END BRACKET CODE	A	B
SA2 12 R01	SA2 B01	X	X

